

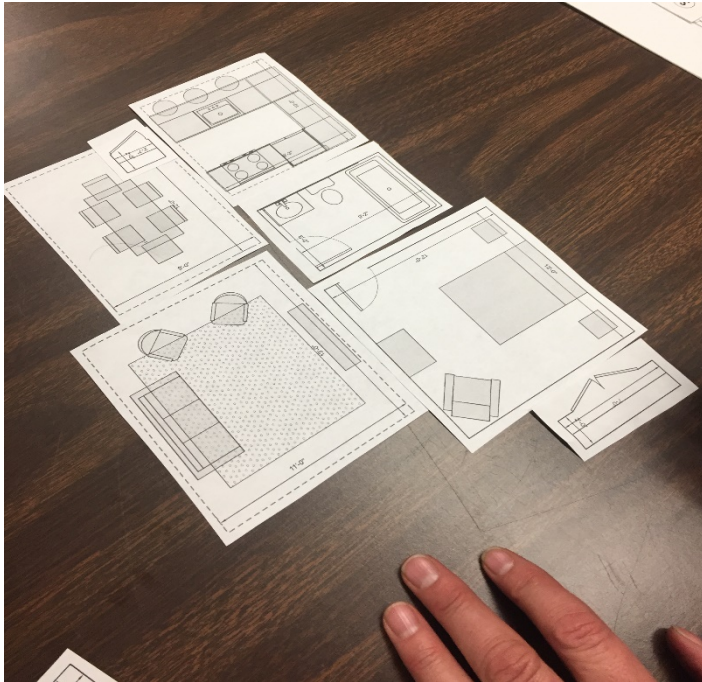

January 2017 Newsletter

BSC engaged in a design workshop to determine the sizes in square feet of the living units – studios, 1 -, 2 -, and 3 – bedrooms, with the guidance of our architects.



Our second workshop tackled the common spaces indoors and outdoors. High priority outdoors are gardens and play areas for children with as much open space as possible on a site of less than an acre. This means that at least part of the building will be 3 or 4 stories high, perhaps staggered to the back to two stories.

Indoors we want a kitchen and a dining area that can be used for large meetings and for performance space. We also want a young children's play room, homework and hangout spaces for older children, space for meetings formal and informal, for music, for arts and crafts, a café, an adults only pub, and workshops for fixing things, wood-working, clay (messy), and electronics.